

## EVOLUTION Fully-framed upper tip-in transom

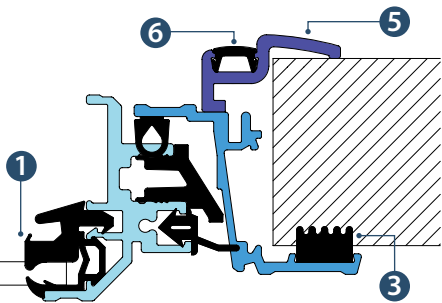

1. Optional quick change or standard wedge type glazing retention
2. Egress windows have  $\frac{3}{4}$  size opening
3. Redesigned & simplified frame-to-bus sealing interface
4. Adjustable tip-in latch assembly permits field adjustment
5. Clamp-ring profile crowned – eliminating need for rubber
6. Optional hidden fastener clamp-ring design

## STORM-TITE Fully-framed upper tip-in transom

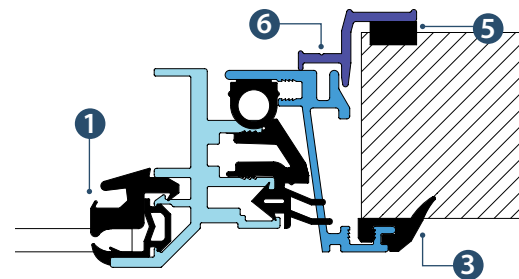

1. Standardized quick-change wedge type glazing retention
2. Egress windows have full size opening
3. Legacy frame-to-bus interface, coextruded seal mechanically affixed to frame
4. Fixed, multi-point tip-in latch assembly restricts field adjustment flexibility
5. Routine inclusion of rubber on clamp-ring sealing surface
6. Standard clamp-ring design with accessible fasteners

### What hasn't changed

- All anodized components
- Same best-in-class water management system
- Can accommodate 4mm to 12mm glazing
- Largest standard sash opening for tip-in transom windows
- All stainless steel fasteners

